

Compartment 1 – (Nature reserve sanctuary area) - This compartment consists of woodland and is part of the west bank of Hayden Water. Public access is limited by vegetation growth and a locked gate to prevent access by the public and club users. To allow wind speed for sailing annual coppicing of one section per year will be allowed to address this issue.

Compartment 2 – (Grassland and woodland) - This area of the Park has been identified with moderate visitor activity. Uses for Angling, sailing and car park. Species present in the area include Kingfisher (*Alcedo atthis*), Pipistrelle Bat (*Pipistrellus pipistrellus*), and Noctule Bat (*Myotis noctula*) and Reed Bunting (*Emberiza citrinella*) that nest in the reedbeds along Hayden Water. The key projects for this area are removing scrub, keeping the pond with some open areas, coppicing and planting around the lake edge

Compartment 3 – (Water Meadow) - This compartment is an example of a scarce habitat, containing a limited number of an identified rare species *Geranium silvaticum* (Narrow-Leaved Water-Dropwort) around the river boundary and is flanked on one boundary by trees and scrub. Bats use the river corridor. Preserve the existing habitat and the protection of identified species. Key projects must scrap, and ponds to increase biodiversity of this area. Requests for events should avoid this area of land.

Compartment 4 – (Reservoir embankment) - Compartment four comprises the Leigh Flood Relief Barrier, a structure that impacts on management objectives throughout the Park. The barrier is owned and managed by the Environment Agency (EA) and is maintained as a close grown grass embankment.

Compartment 5 – (Woodland and meadow) - This compartment comprises a variety of habitats and contributes strongly

to the wildlife diversity and character of the Park. Along 'The Straight Mile' (woodland ridge) Damaselles, Dragonflies and Butterflies are common, this area may also be attractive for Bat species. The Straight Mile woodland is a good habitat for Bird species and woodland edges for the plants.

Compartment 6 – (Heusenstamm Wood) - A mixed species broadleaved woodland which is still young circa 1987 but is establishing well, and now attracting Dragonflies and Butterflies. This woodland is located on the former site of the so called 'Tonbridge Lido' or 'Weir Pool', both now filled in and removed.

Compartment 7 – (The Shallows) - Flanked to the south by the original River Medway and Stone Lock, the river is now

heavily silted through lack of water flow, accept in times of flood. The area contains a variety of common flora and is an important site for invertebrates and feeding birds, as are the reed beds. Species present at this locality include Kingfishers (*Alcedo atthis*) and Damselflies. A pond dipping platform is located in this compartment.

Compartment 8 – (River Meadow) - Bordering the River Medway the area contains examples of wildflower meadow and old woodland and the remains of the old Stone Lock. Species present alongside the river are Common Darter Dragonfly (*Zygoptera aristatum*), Migrant Hawker Dragonfly (*Aeshna mixta*) and Banded Demoiselle (*Galopteryx splendens*). Key projects for this area are to increase the biodiversity of the meadow areas by removing arising when cut and opening up bare ground for natural regeneration. The future management of the Stone Lock is a key project.

Compartment 9 – (Barden Lake & Woodlands) - Dominated by Barden Lake and Woodlands - Dominated by Barden Lake the area is bordered by woodland (Barden Shaw and Audley Wood) and the railway line. The area is subject to a high level of public use for informal recreation. A number of species visit the woodland called Barden Shaw including Nightingale (*Luscinia megarhynchos*) and Serotine bat (*Eptesicus serotinus*). Kingfishers (*Alcedo atthis*) are also present along the river. Around the lake Dyer's Greenwood (*Castalia fructosa*) and Dragonfly species have been noted. Key projects are establishing planting around the lake edge control of Canada Geese and re-vegetating the bare soil at the end of the lake.

Compartment 10 – (Main entrance area) - An area that is subject to the highest level of public use, consisting of the main car park, toilet block, picnic areas, children's play area and designated dog exercise area and where the mobile cafeteria service operates from. Hedgerows around

the car park/ play area boundary are now well established. Hedgerelaying to the rear of the play area has also been a great success. The key project is to establishing a new use for Tile Barn Field.

Compartment 11 – (Woodland and Car Park) - Predominantly Hayden Water car park and the informal BMX track but also containing a small section of woodland and the man-made Bat Cave.

Abridged version from the management plan text

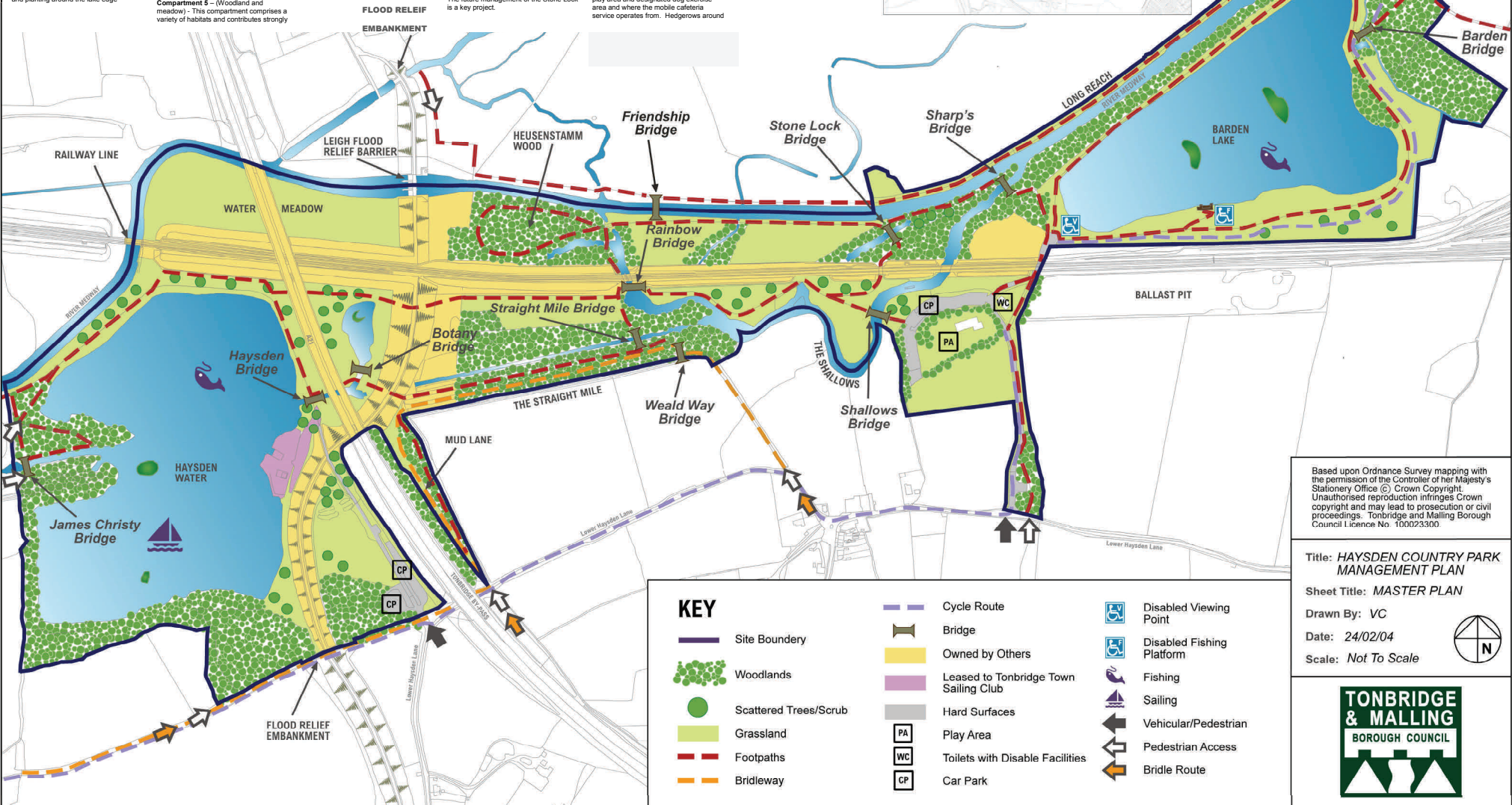
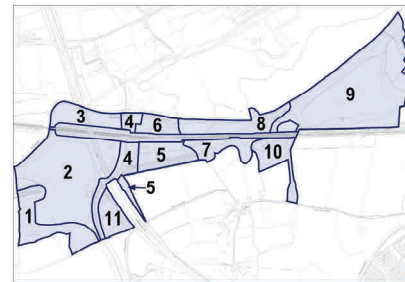

Based upon Ordnance Survey mapping with the permission of the Controller of Her Majesty's Stationery Office © Crown Copyright. Unauthorised reproduction infringes Crown copyright and may lead to prosecution or civil proceedings. Tonbridge and Malling Borough Council Licence No. T10123300.

Title: HAYSDEN COUNTRY PARK MANAGEMENT PLAN
 Sheet Title: MASTER PLAN
 Drawn By: VC
 Date: 24/02/04
 Scale: Not To Scale

| KEY | |
|-----|---------------------------------------|
| | Cycle Route |
| | Bridge |
| | Owned by Others |
| | Woodlands |
| | Leased to Tonbridge Town Sailing Club |
| | Scattered Trees/Scrub |
| | Grassland |
| | Footpaths |
| | Bridleway |
| | Disabled Viewing Point |
| | Disabled Fishing Platform |
| | Fishing |
| | Sailing |
| | Vehicular/Pedestrian |
| | Pedestrian Access |
| | Bridle Route |
| | Play Area |
| | Toilets with Disable Facilities |
| | Car Park |

